

적 용 모 델	ASS'Y NO	등록일	승인

구분	치수	0.5 초과 10 이하	10 초과 50 이하	50 초과 150 이하	150 초과 250 이하	250 초과 400 이하	400 초과 600 이하	600 초과 1000 이하	각 도
기계가공		±0.05	±0.08	±0.13	±0.17	±0.23	±0.3	±0.5	±0.1°
제 관		±0.5	±1	±2	±3	±4.5	±8	±11	±1°
불꽃절단		±1	±1.5	±2	±2.5	±3.5	±4.5	±10	

ECO NO	ISSUE	DATE	DR	DC	CH	
신 규 출 도						

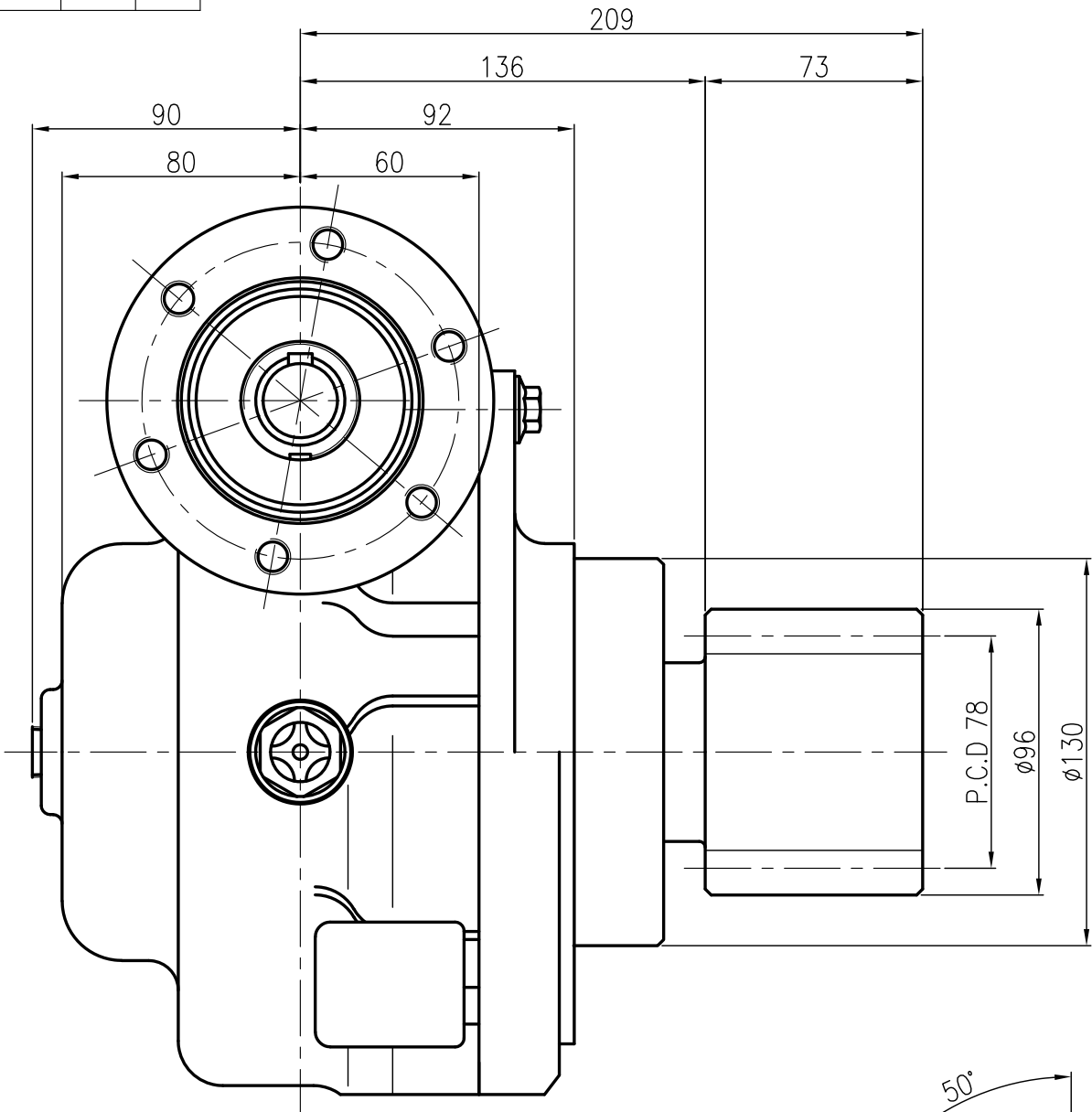

SECTION A-A

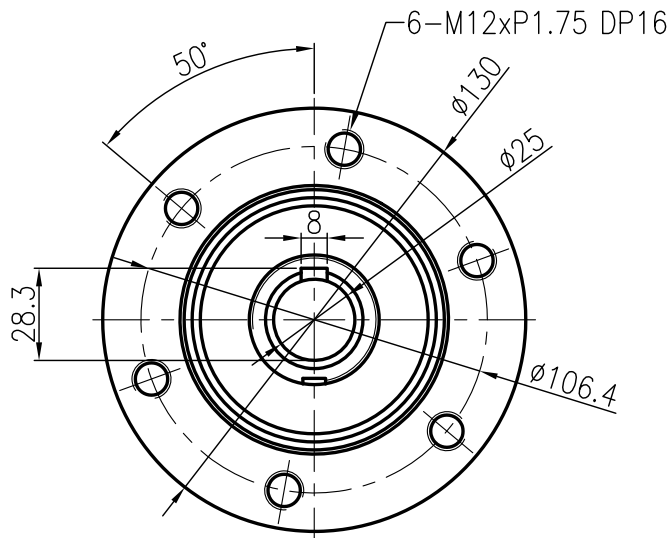
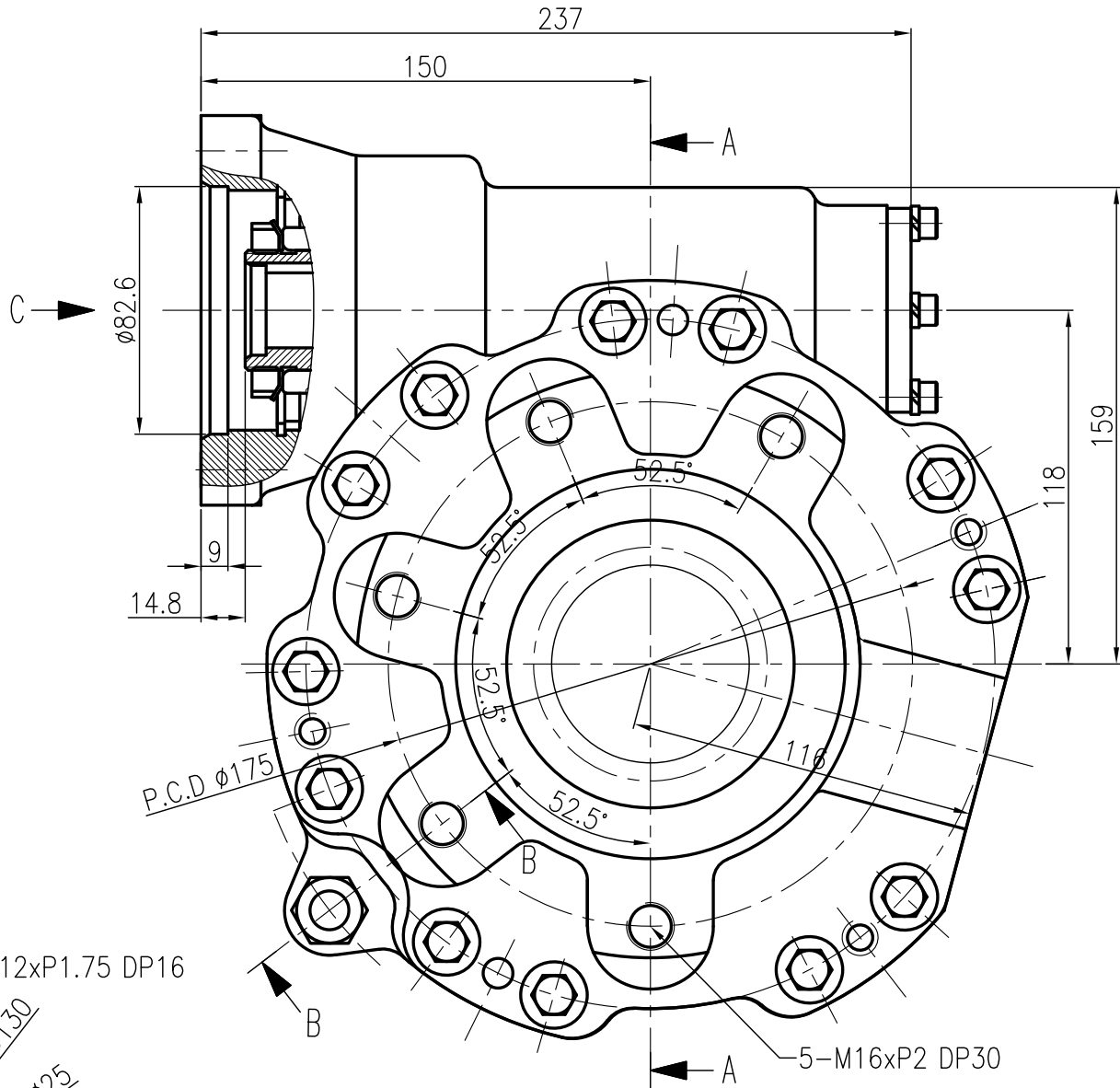

VIEW C

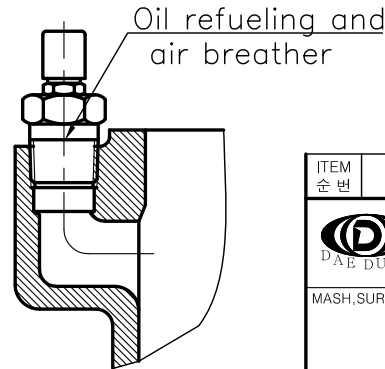

SECTION B-B

PINION GEAR		
T O O L	Tooth form	Profile shifted
	Module	6
	Pressure angle	20°
Number of teeth		13T
Coefficient profile shifted		+0.517
P . C . D		Ø78

NOTE

- Reduction ratio : 1 : 44
- Input Torque : 13 Kgf.m
- Output Torque : 286 Kgf.m
- Noise 85dB Below
- Be sure to lubricate the oil before assembling the reducer to the equipment.
(Recommended oil specification: ISO VG220)
- The input and output torque values listed are theoretical and may differ from actual capabilities and depend on the operating pressure and size of the motor.
- Products made of CASE and castings may differ from actual dimensions due to tolerance of strain and draft angle of castings.

ITEM 순번	PARTS No. 품번	PART NAME 품명	MATERIAL 재질	Q'TY 수량	REMARK 비고
NAME (명칭) GEAR BOX ASSEMBLY					
5TON SWING					
MASH,SURF,TEXTURE (표면거칠기)					
D R 제 도					
D E 상 계					
C K 검 토					
A P 승인					
SCALE					
SHEET					
OF					
DWG. NO.					
도면 번호					
WT EST					
중량 ACT					
SURFACE TREAT (표면처리)					
ISSUE(개정)					

07-04-T000